



£64,995

TW18 Lakesway Holiday Home and Lodge Park, Kendal LA8 8EQ

Caravan | 3 Bedrooms | 2 Bathrooms



Step Inside

Key Features

- Unobstructed South Facing views
- 12 month park
- No onward chain
- Stamp duty exempt

Main Particulars

Carnaby Silverdale - Lakesway Holiday Home and Lodge Park, Kendal Levens

Welcome to the Carnaby Silverdale, a beautifully designed holiday home located in the serene and scenic Lakesway Holiday Home and Lodge Park. Nestled in the heart of Kendal Levens, this charming retreat offers the perfect blend of comfort, style, and breathtaking natural beauty, making it an ideal choice for families and groups seeking a memorable getaway.

As you step inside, you'll immediately appreciate the spacious layout and modern furnishings that create a warm and inviting atmosphere. The holiday home features three well-appointed bedrooms: a cozy twin room perfect for kids or friends, a delightful single room for those who prefer their own space, and a luxurious double bedroom with an en-suite WC for added privacy and convenience.

The heart of the home is the open-plan living area, where you'll find a comfortable lounge that's perfect for relaxing after a day of exploring. The fully equipped kitchen is designed for ease, allowing you to prepare delicious meals to enjoy together at the dining table, creating lasting memories with loved ones.

One of the standout features of the Carnaby Silverdale is its exceptional outdoor space. Step onto the expansive decking and be captivated by the unobstructed south-facing views. Here, you can enjoy the stunning sunrises that greet you each morning and watch the sun set gracefully to the right of the home, bathing the entire area in warm, golden light throughout the day. It's the perfect spot for morning coffees, alfresco dining, or simply unwinding with a good book as you take in the peaceful surroundings.

Located within the scenic Lakesway Holiday Home and Lodge Park, you'll have access to a variety of on-site amenities and activities. Take leisurely walks through the park's lush landscapes or venture out to explore the breathtaking Lake District, with its stunning lakes, mountains, and charming villages. Whether you're interested in hiking, cycling, or simply enjoying the tranquil beauty of nature, there's something for everyone.

The Carnaby Silverdale is not just a holiday home; it's a sanctuary where you can escape the hustle and bustle of everyday life and reconnect with family and friends. With its prime location, stylish accommodations, and incredible views, this is the ideal base for your next adventure.

Don't miss the chance to experience all that this wonderful holiday home has to offer. Book your stay at the Carnaby Silverdale today, and start creating unforgettable memories in the heart of the Lake District!



Approx Gross Internal Area
42 sq m / 455 sq ft

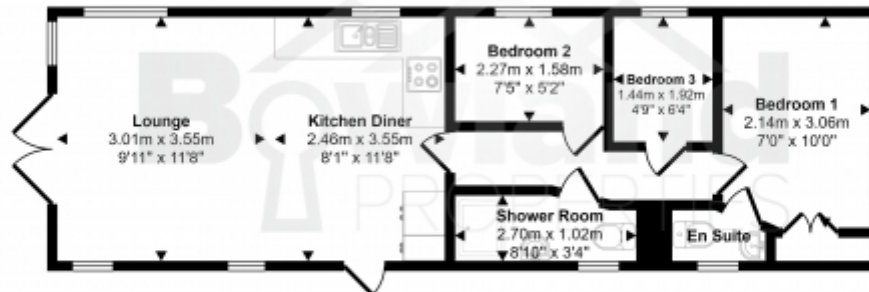

Floorplan

This floorplan is only for illustrative purposes and is not to scale. Measurements of rooms, doors, windows, and any items are approximate and no responsibility is taken for any error, omission or mis-statement. Icons of items such as bathroom suites are representations only and may not look like the real items. Made with Made Snappy 360.

This floorplan is for illustrative purposes only and the location of doors, windows and other items are approximate.

Agents notes: All measurements are approximate and for general guidance only and whilst every attempt has been made to ensure accuracy, they must not be relied on. The fixtures, fittings and appliances referred to have not been tested and therefore no guarantee can be given that they are in working order. Internal photographs are reproduced for general information and it must not be inferred that any item shown is included with the property. Copyright © 2024 15661612 Registered Office: , Yealand Redmayne, Carnforth, Lancs, LA5 9RN



www.bowlandproperties.co.uk