



£154,490 Offers In Region Of

Private sale - Coniston Drive 12 South Lakeland Leisure Village, Carnforth LA6 1BH

Lodge | 3 Bedrooms | 2 Bathrooms



# Step Inside

---

## Key Features

- Rare lakefront plot
- Hot tub
- Ideal investment with provable income
- 49 year licence
- L shape decking
- Copious parking

## Main Particulars

Reduced for a quick sale, fantastic pre-season opportunity to purchase a superbly located lodge on very desirable lodge park.

Looking for the ideal retreat to create unforgettable memories? Look no further...

Situated on the edge of the stunning Lake District, the Willerby Clearwater offers the perfect escape for all.

This lodge offers Lakeside Luxury perfect for enjoying the serene beauty of lakeside living with direct access to the water. Unwind in the private hot tub, relax on the spacious outdoor deck with comfortable furniture, and take in the picturesque views.

The Willerby Clearwater is the perfect home away from home that comfortably sleeps up to 8 guests with 1 King bed, 2 twin bedrooms, and a double sofa bed in the living area, along with a fully equipped kitchen, cozy dining and seating areas, and entertainment options including a TV with Netflix. With 2 shower rooms and a spacious layout, offers all the comforts of home.

Combining a well-structured layout, with cool tones to create the ultimate stress-free environment, the Clearwater stands out from the rest. With an abundance of windows, bring the outside in, the perfect escape...

Relax & Explore, South Lakeland is situated on the peaceful fountain lake, where swans and ducks frequently visit, Willerby Clearwater provides a perfect spot to relax and recharge. Plus, with the beautiful Lake District on your doorstep, there's plenty to see and do.

Fantastic Amenities located in the South Lakeland Leisure Village, you'll have access to a bar, restaurant, beauty salon, and the leisure complex featuring a swimming pool, gym, and fitness classes (passes available at reception).



Approx Gross Internal Area  
74 sq m / 799 sq ft

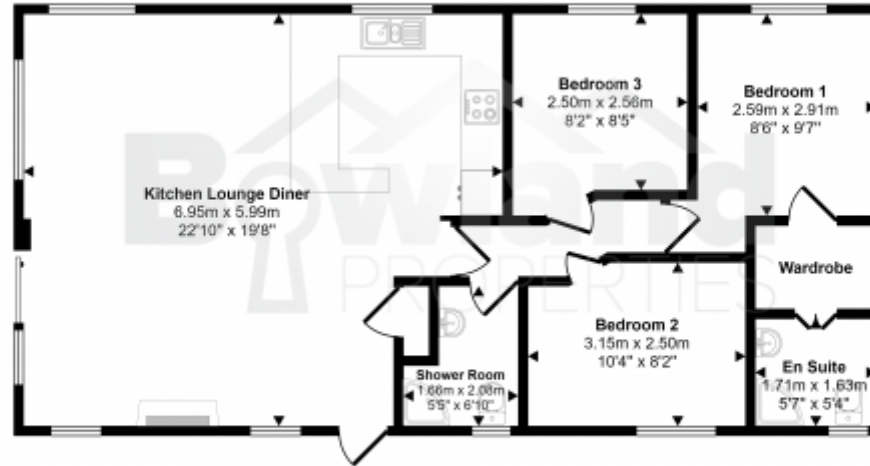

Floorplan

This floorplan is only for illustrative purposes and is not to scale. Measurements of rooms, doors, windows, and any items are approximate and no responsibility is taken for any error, omission or mis-statement. Icons of items such as bathroom suites are representations only and may not look like the real items. Made with Made Snappy 360.

This floorplan is for illustrative purposes only and the location of doors, windows and other items are approximate.

Agents notes: All measurements are approximate and for general guidance only and whilst every attempt has been made to ensure accuracy, they must not be relied on. The fixtures, fittings and appliances referred to have not been tested and therefore no guarantee can be given that they are in working order. Internal photographs are reproduced for general information and it must not be inferred that any item shown is included with the property. Copyright © 2025 15661612 Registered Office: , Yealand Redmayne, Carnforth, Lancs, LA5 9RN

